

1 - Upper Assembly & Components

- 980 Connector Screw Set (69)
- HFG301 Fastener-10-32 x .250 18-8 Slt Fi
- 981 Wedge Set (26)
- HFG216 Connector Wedge
- 971 Locking Collar-w/Insert
- 971Collar Collar
- HFG315 Plastic Insert
- 963 Trim Cap
- 958 Extrusion-7' Luff
- 972 Extrusion-2' Luff
- 960 Connector-10"
- HFG350 Connector-Split Top (optional)
- 961 Connector-13" Bottom
- 1037 Halyard Swivel
- 4456 Label-³/₈" x 2 ¹/₈"
- 2125 Shackle-10 mm Twist
- 2124 Shackle-10 mm Bow
- HCP726 Snap Ring-Large (order 2)
- HCP725 Snap Ring-Small
- HBB7 Ball Bearing-³/₈" Torlon (order 81)
- HBB21 Ball Bearing-¹/₂" Torlon (order 23)
- 1038 Torque Tube
- 4753 Label-Small Red Oval
- HFS337 Fastener-M10x1.50x40 316 Sk Cap (order 2)
- 962 Feeder
- HFS192 Fastener-10-32 x ³/₈" 18-8 Slt Ov (order 2)
- HFG135 Extrusion Set (10 Long, 1 Short)
- 958 Extrusion-7' Luff
- 972 Extrusion-2' Luff
- HFG637 Fastener Set-Torque Tube (4)
- HFS336 Fastener-M8x1.25x16 A4 Sk Cap

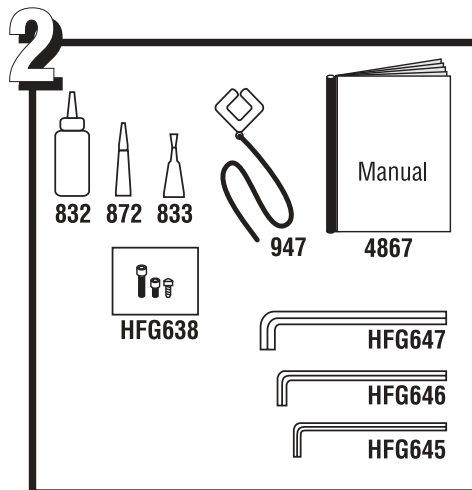

2 - Accessories

- 4867 Manual - Furling
- 833 Loctite - Blue
- 832 Loctite - Red
- 872 Super Glue
- 947 Prefeeder - Phenolic w/Line
- HFG638 Fastener Set - Spare
- HFG645 Wrench - M6 Allen Short
- HFG646 Wrench - M8 Allen Short
- HFG647 Wrench - M10 Allen Long

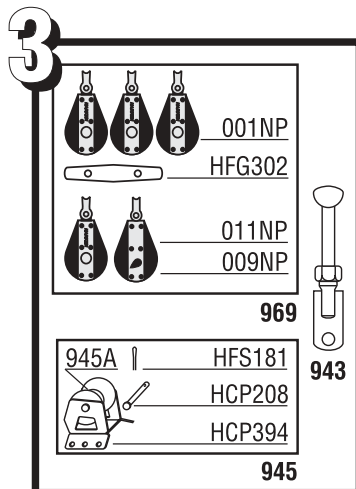

3 - Optional Parts

- 969 Kit - Lead Block
- 009NP Block - 3.00" Hex Stbd
- 011NP Block - 3" Cruising
- 001NP Block - 2.25" Swivel
- HFG302 Cleat - 5" Black
- 943 Isomat Adapter - ³/₄" (19 mm)
- 945 Halyard Restrainer - Large
- 945A Sheave & SS Inner Race Only
- HCP208 Clevis Pin - ⁵/₁₆" x 1.250" 18-8
- HCP394 Bracket - Large Halyard Restrainer
- HFS181 Cotter Pin - ³/₃₂" x .750" 18-8

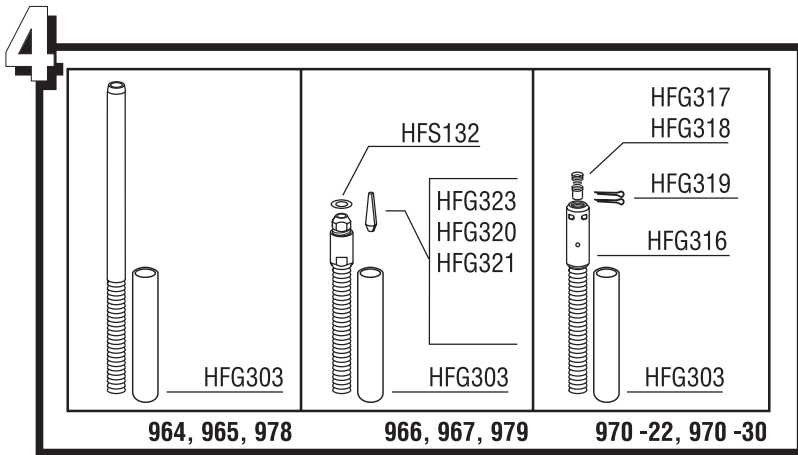

4 - Studs & Components

Swage Studs

- HFG303 Stud-Cap- $\frac{7}{16}$ " ID x 5.5" Red
- 964 Stud- $\frac{7}{16}$ " (11 mm) Swage
- 965 Stud- $\frac{1}{2}$ " Swage
- 978 Stud-12 mm Swage

Sta-Lok Studs

- HFG303 Stud-Cap- $\frac{7}{16}$ " ID x 5.5" Red
- 966 Stud- $\frac{7}{16}$ " (11 mm) Sta-Lok
- HFG323 Wedge- $\frac{7}{16}$ " (11 mm) Sta-Lok
- HFS132 Washer- $\frac{1}{2}$ " .062 x .531 x 1.250 18-8 FW
- 967 Stud- $\frac{1}{2}$ " Sta-Lok
- HFG320 Wedge- $\frac{1}{2}$ " Sta-Lok
- HFS132 Washer- $\frac{1}{2}$ " .062 x .531 x 1.250 18-8 FW
- 979 Stud 12 mm Sta-Lok
- HFG321 Wedge-12 mm Sta-Lok
- HFG265 Wedge-12 mm Sta-Lok **Dyform**
- HFS132 Washer- $\frac{1}{2}$ " .062 x .531 x 1.250 18-8 FW

Rod

- HFG303 Stud-Cap- $\frac{7}{16}$ " ID x 5.5" Red
- 970 -22 Stud -22 Rod Adpt w/Nosepiece
- HFG316 Stud-Main Body
- HFG317 Nosepiece -22
- HFG319 Cotter Pin- $\frac{3}{32}$ " x 1.750" 18-8
- 970 -30 Stud-30 Rod Adpt w/Nosepiece
- HFG316 Stud-Main Body
- HFG318 Nosepiece-30
- HFG319 Cotter Pin- $\frac{3}{32}$ " x 1.750" 18-8

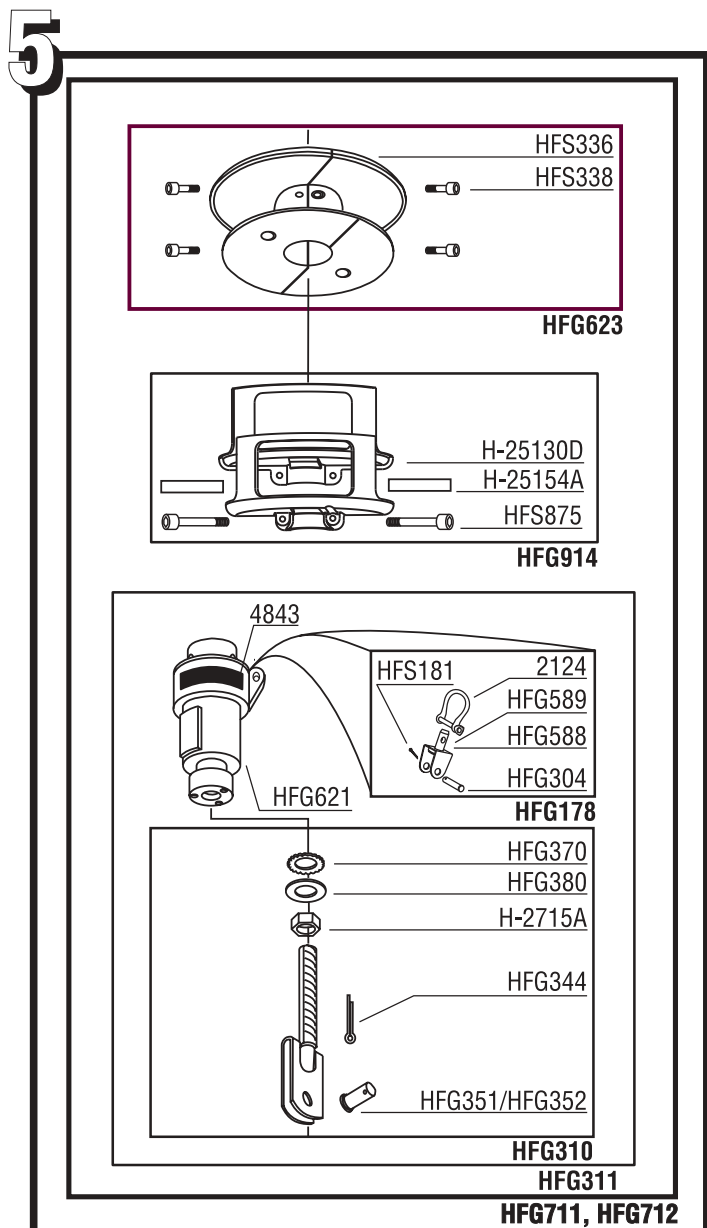

5 - Drum Assembly & Components

- HFG711 Drum Assembly $\frac{3}{4}$ " Clevis - Complete
- HFG712 Drum Assembly $\frac{7}{8}$ " Clevis - Complete
- HFG623 Spool Assembly-Complete
- HFS336 M8 x 1.25X16 A4 SK Cap (4)
- HFS338 M4 X 8 18-8 PH OV (2)
- HFG914 Drum Assembly $\frac{7}{8}$ " Clevis - Complete
- H-25130D Line Guard (order 2)
- HFS875 Fastener-M12 x 1.75 x 70 mm SK Screw (order 2)
- H-25154A Mylar Guard Clamp Shim(order 2)
- HFG310 Lower Toggle- $\frac{3}{4}$ " Clevis Pin
- HFG311 Lower Toggle- $\frac{7}{8}$ " Clevis Pin
- HFG351 Clevis Pin- $\frac{3}{4}$ " Lower Toggle
- HFG352 Clevis Pin- $\frac{7}{8}$ " Lower Toggle
- HFS344 Cotter Pin
- H-2715A Lock Nut
- HFG370 Lock Wash-Toggle
- HFG380 Flat Washer-Lower Toggle
- HFG621 Hub-w/o Lower Toggle
- 4843 Label Tack Swivel
- HFG178 Tack Shackle Assembly
- 2124 Shackle-10 mm Bow
- HFG588 Swivel Bracket w/Swivel Pin
- HFG304 Clevis Pin- $\frac{3}{8}$ " X 1.500" 18-8
- HFS181 Cotter Pin-.094 x .750 18-8